

<b>FORD MONDEO VIGNALE</b>	Nº de homologación Official approval number Prüfung Nr. Nº d'homologation
------------------------------------	--

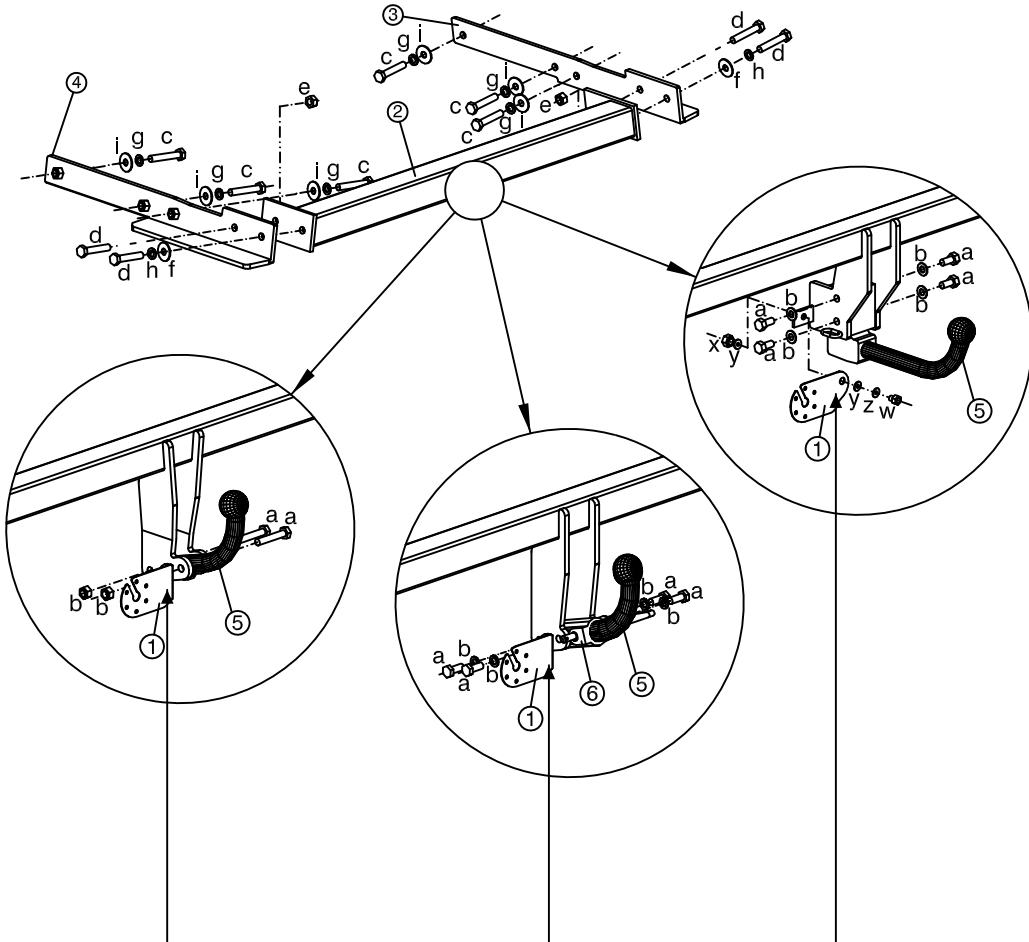

Made by LAFUENTE (SPAIN)  
 Tlf: (+34) 952 625 840  
 www.lafuente.eu

**Eg** 55R -01 2128

TIPO EE0470	D 11,26 kN
CLASE A-50X	S 90 kg

Made by LAFUENTE (SPAIN)  
 Tlf: (+34) 952 625 840  
 www.lafuente.eu

**Eg** 55R - 01 2129

TIPO EE1470	D 11,26 kN
CLASE A-50X	S 90 kg

Made by LAFUENTE (SPAIN)  
 Tlf: (+34) 952 625 840  
 www.lafuente.eu



**Eg** 55R - 01 2130

TIPO EE4470	D 11,26 kN
CLASE A-50X	S 90 kg

M.M.R.	S	D
2.200 kg.	90 kg.	11,26 kN

Par de apriete para los tornillos Tightening torque for bolts Schrauben Drehmoment Couple de serrage pour vis						
mm	6	8	10	12	14	16
Nm	10	25	55	85	135	200

Enganche homologado según Reglamento nº 55 CEPE  
 Hitch officially approved in accordance with Regulation nº 55 CEPE  
 Geprüfte Kupplung gemäß Reglement nº 55 CEPE  
 Crochet homologué selon la Réglementation nº 55 CEPE

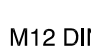
ELEMENTOS DE UNIÓN / CONNECTION COMPONENTS DAZUGEHÖRENDENDEN TEILEN / ÉLÉMENTS DE RACCORD			
BOLA / BALL / KUGEL / BOULE		VEHÍCULO / VEHICLE FAHRZEUG / VÉHICULE	
		c	6 x M10x40 DIN 933 8.8
a	2 x M12x65 DIN 931 8.8	d	4 x M12x40 DIN 933 8.8
b	2 x M12 DIN 985 8	e	2 x M12 DIN 985 8
		f	2 x M12 DIN 125 -
		g	6 x M10 DIN 127 -
a	4 x M12x25 DIN 933 8.8	h	2 x M12 DIN 127 -
b	4 x M12 DIN 125 -	i	6 x M10 DIN 9021 -
		w	1 x M10x30 DIN 933 8.8
a	4 x M12x 25 DIN 931 8.8	x	1 x M10 DIN 985 8
b	4 x M12 DIN 125 -	y	2 x M10 DIN 125 -
		z	1 x M10 DIN 2093 -

Este documento debe ser presentado en la I.T.V. junto con el certificado de montaje.  
 HNOS.SÁNCHEZ-LAFUENTE,S.A. no asume ningún tipo de responsabilidad por daños causados por usos inadecuados.



EE0470



EE1470



EE4470

# FORD MONDEO

# FORD VIGNALE

## BERLINA/FAMILIAR

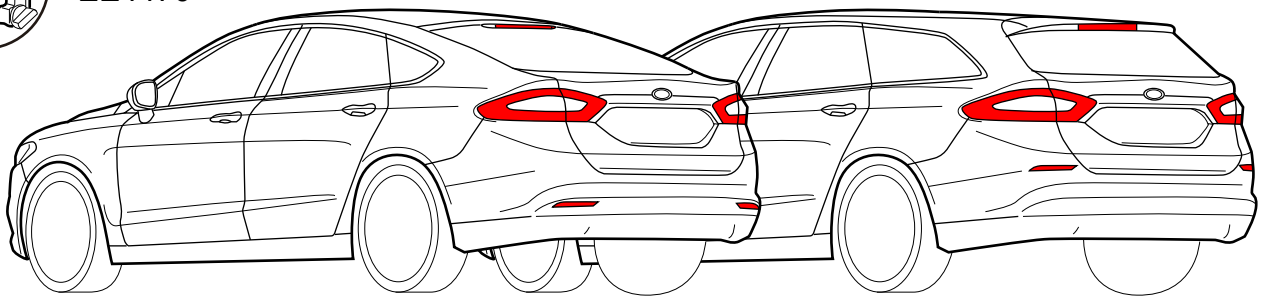

Instrucciones de montaje - Installation instructions - Notice de montage - Montage- og driftsvejledning

1

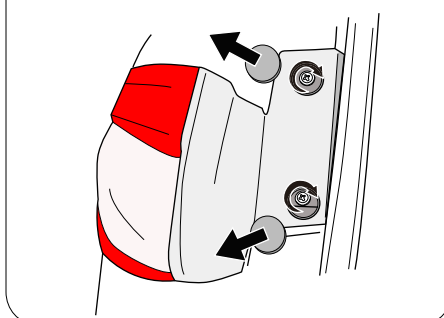
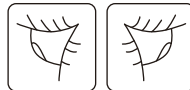
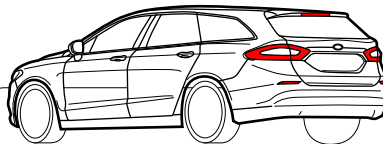
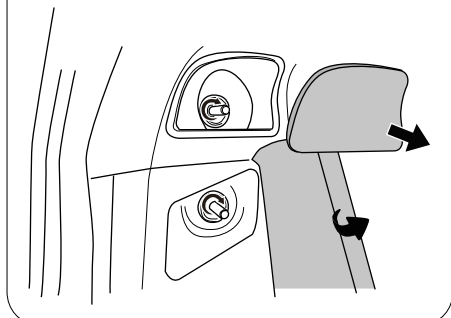
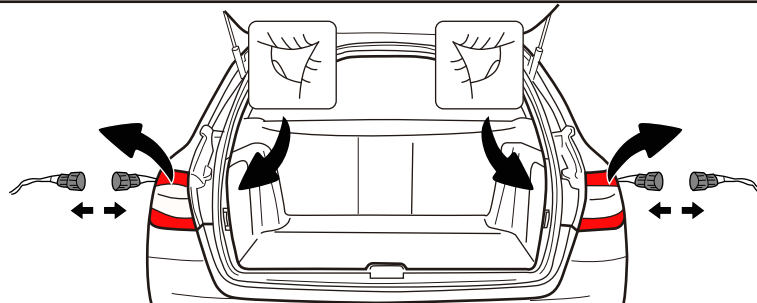

**VIGNALE**

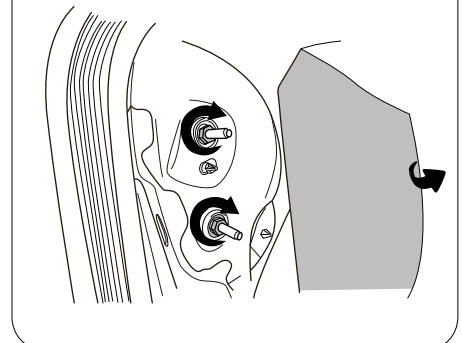

2

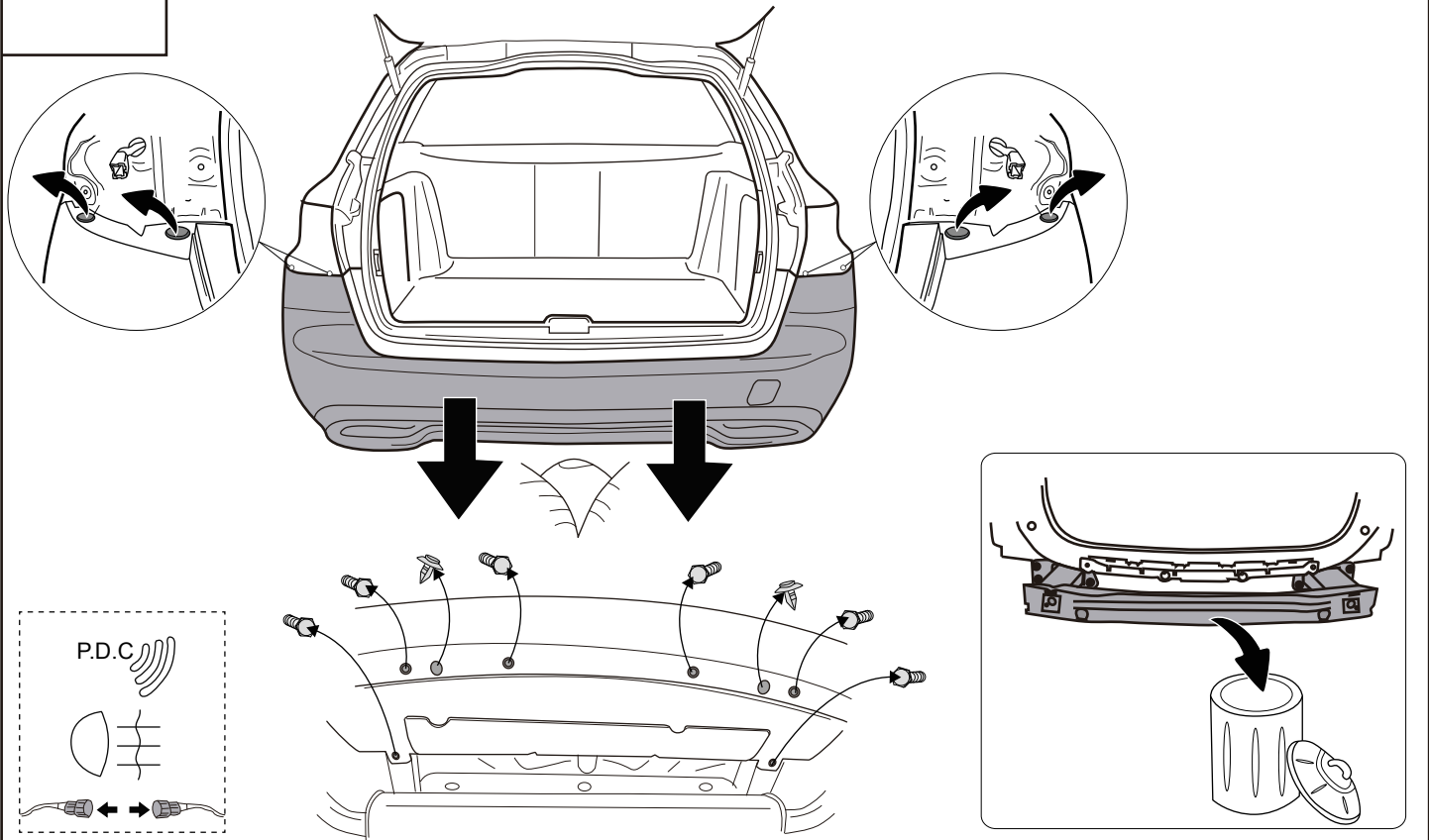

3

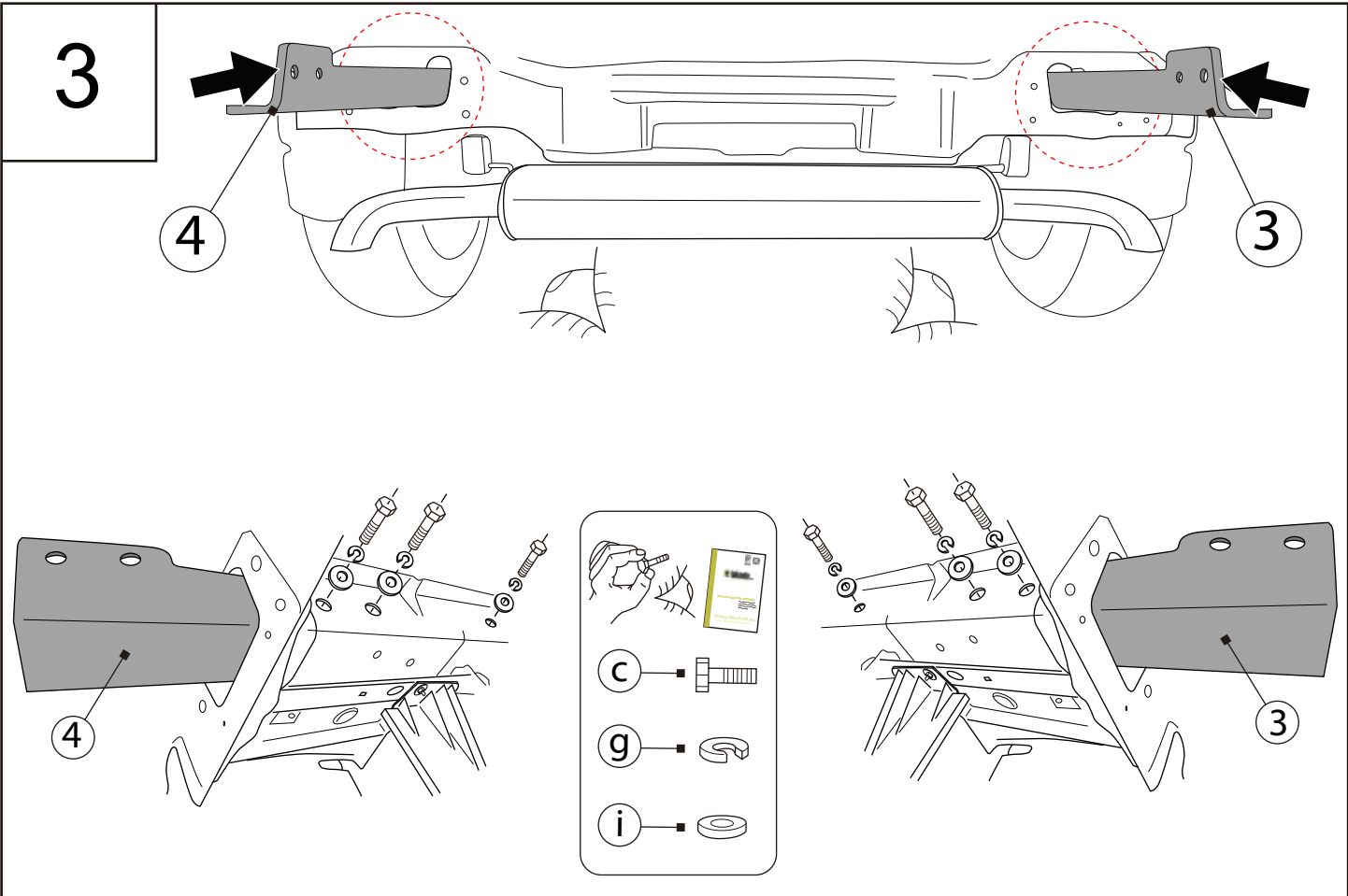

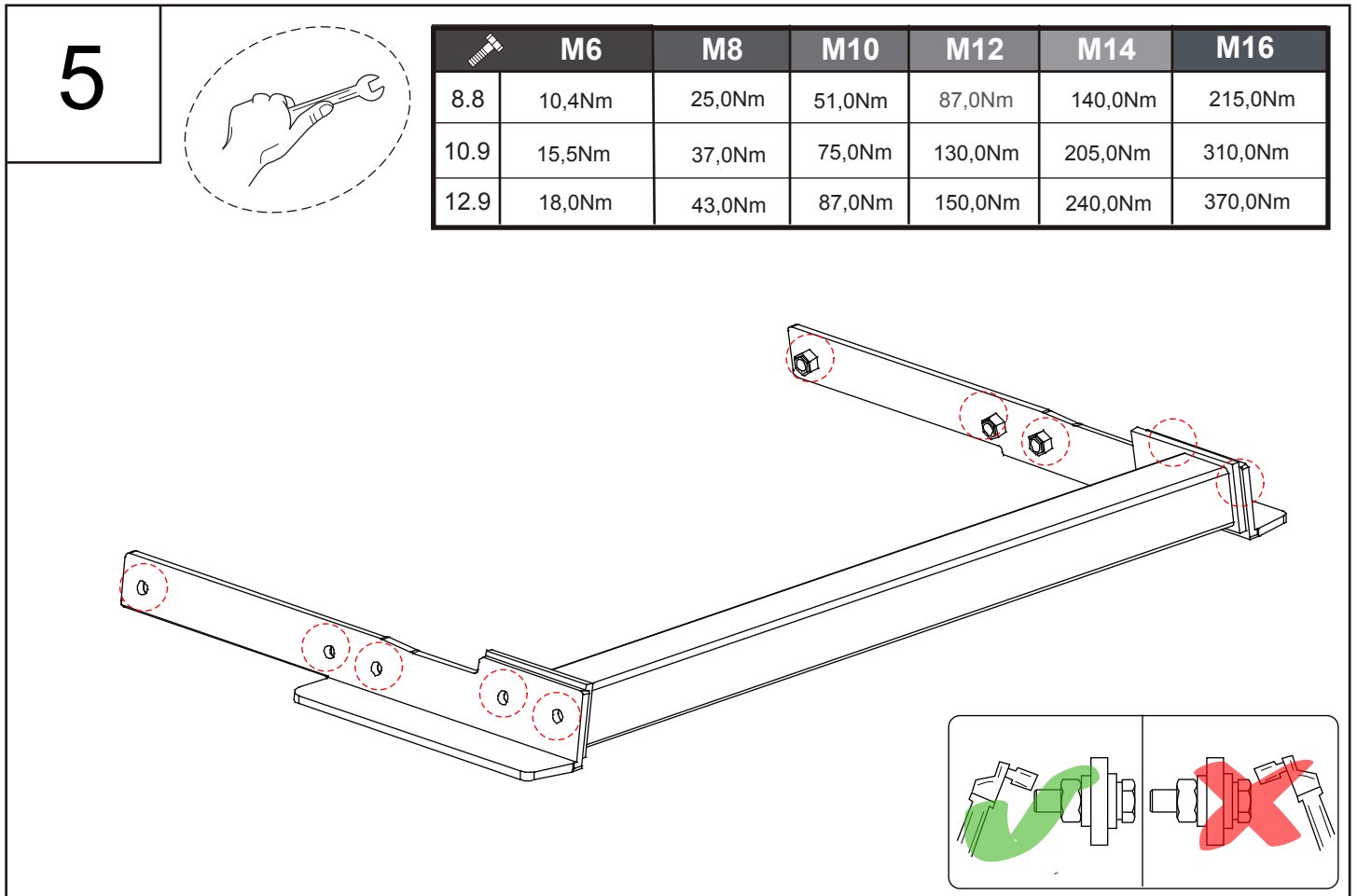
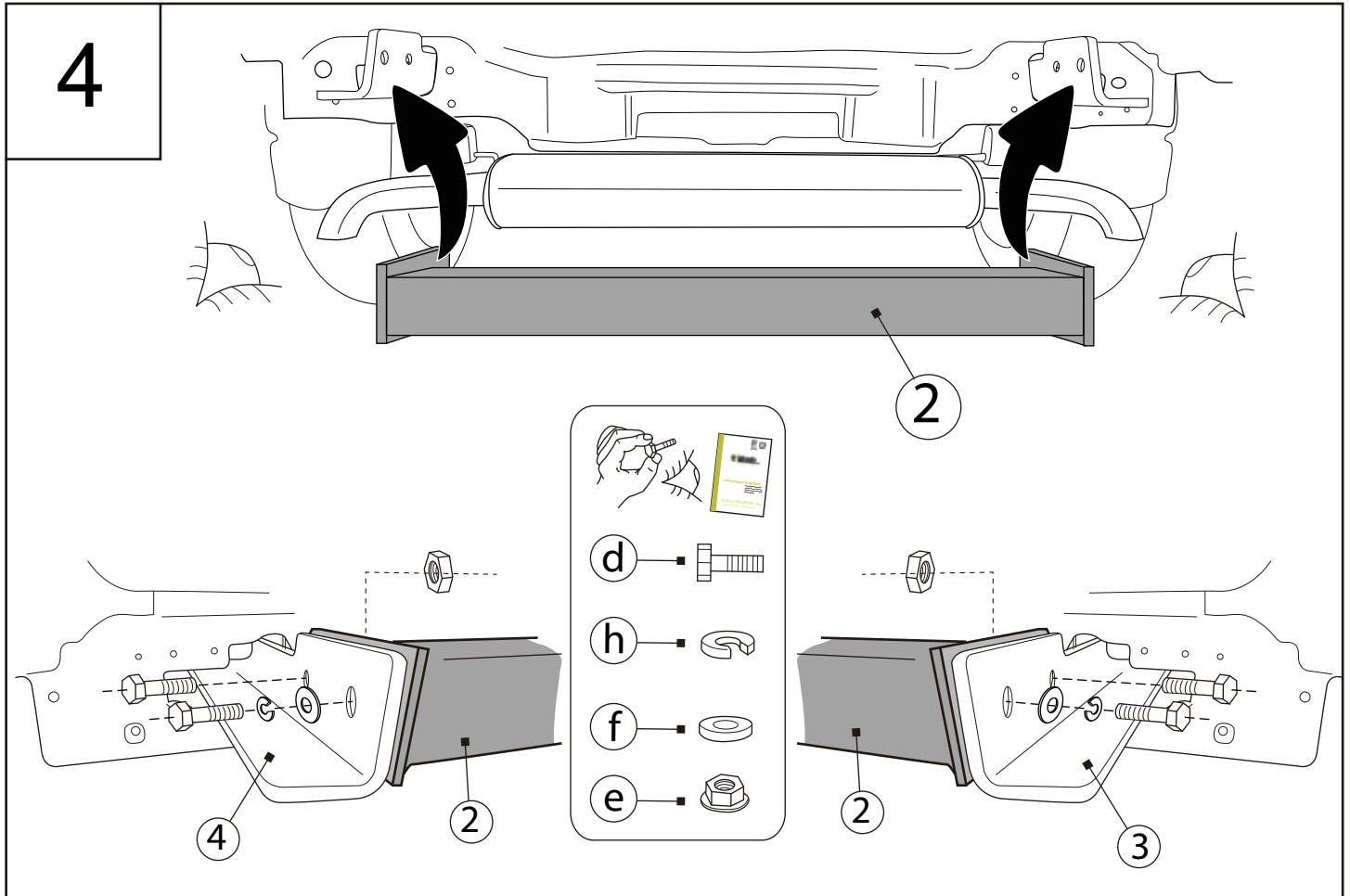

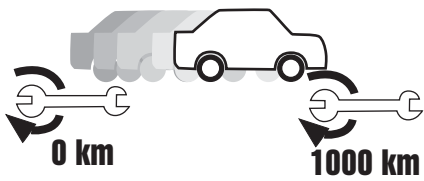
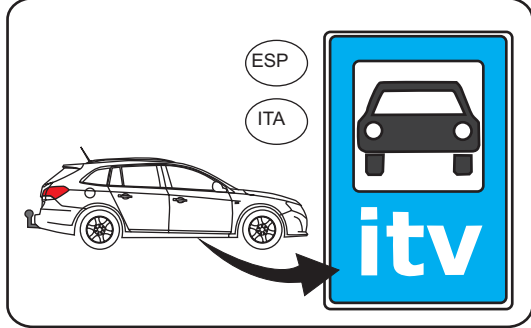
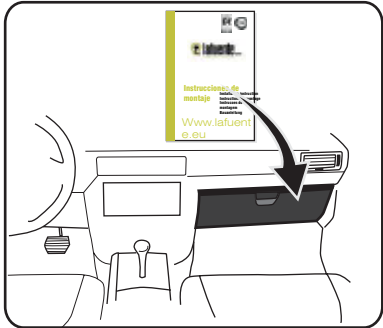
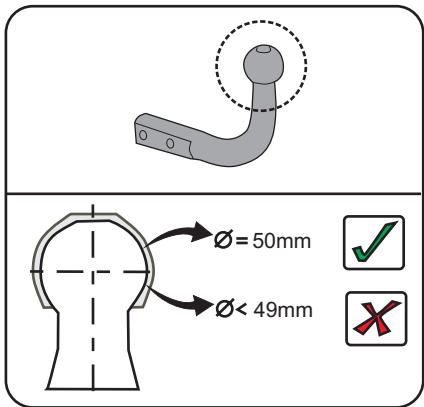
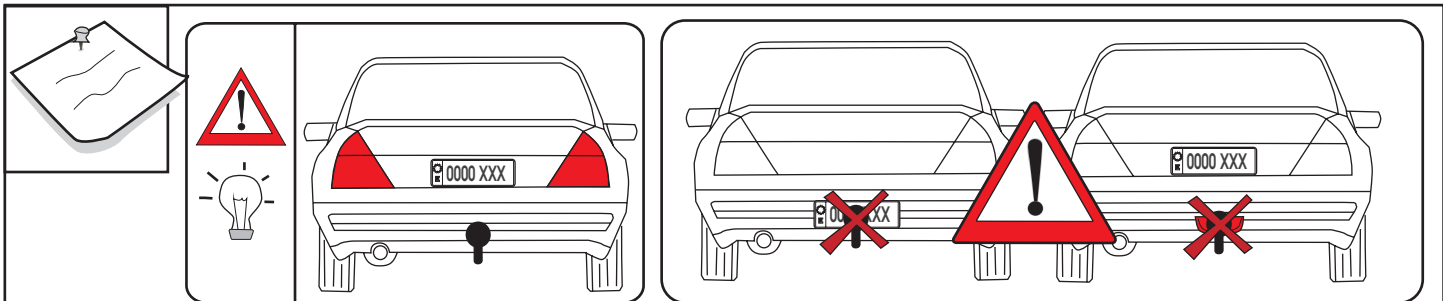
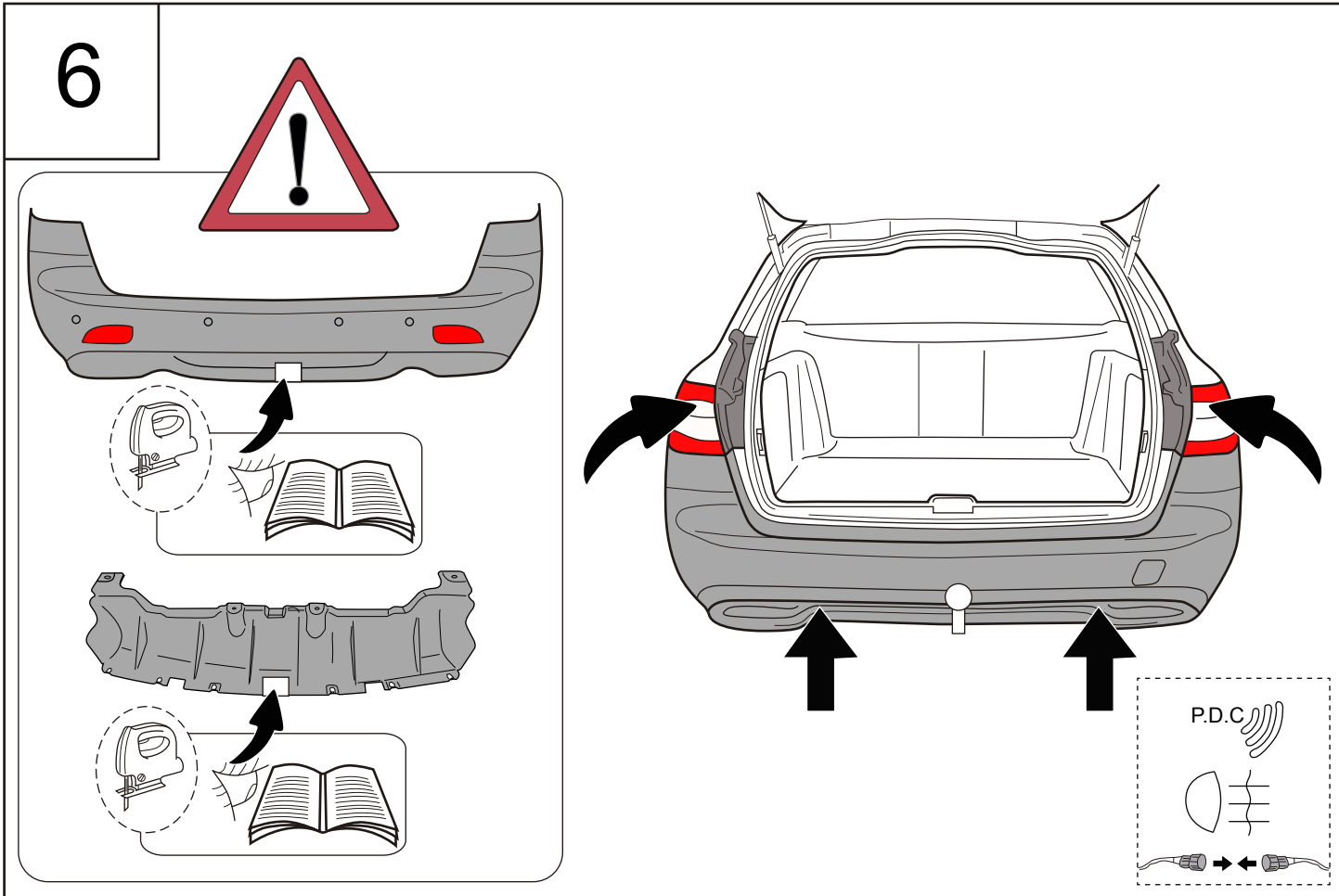

	M6	M8	M10	M12	M14	M16
8.8	10,4Nm	25,0Nm	51,0Nm	87,0Nm	140,0Nm	215,0Nm
10.9	15,5Nm	37,0Nm	75,0Nm	130,0Nm	205,0Nm	310,0Nm
12.9	18,0Nm	43,0Nm	87,0Nm	150,0Nm	240,0Nm	370,0Nm



# CORTE CARCASA INFERIOR

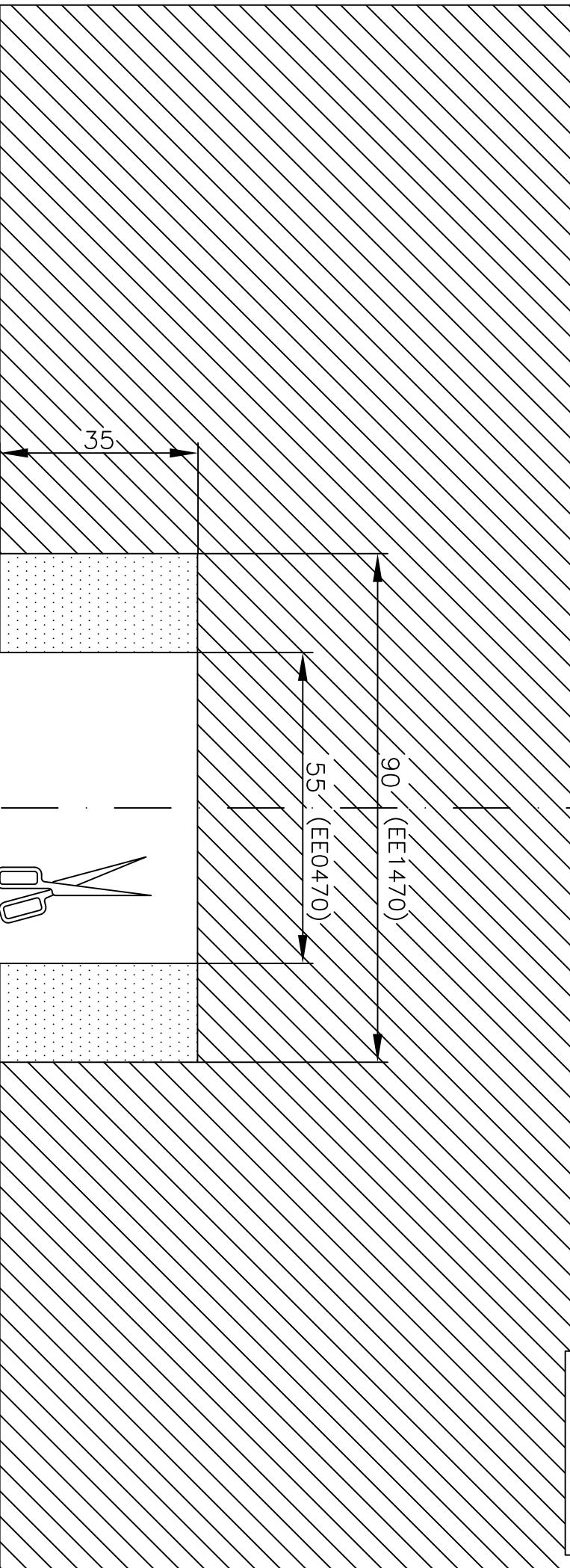
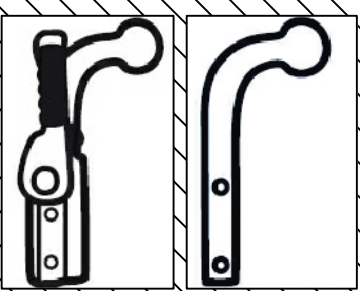

LINEA CENTRAL DE LA CARCASA



Dibujo:  
CORTE CARCASA INFERIOR  
FORD MONDEO

Escala:  
1:1

UNIDADES EN  
mm

EE0470-EE1470

Rev.  
P1



# CORTE CARCASA INFERIOR

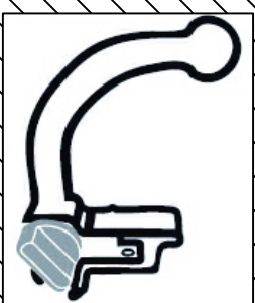

215

45

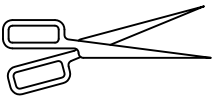

100

60

LINEA CENTRAL DE LA CARCASA



Dibujo:  
CORTE CARCASA INFERIOR  
FORD MONDEO

Escala:  
1:1

UNIDADES EN  
mm

EE4470

Rev.  
P1

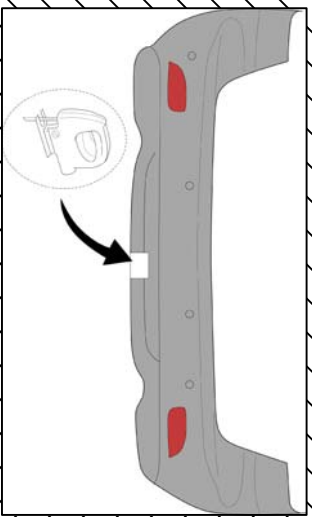

# CORTE PARAGOLPES

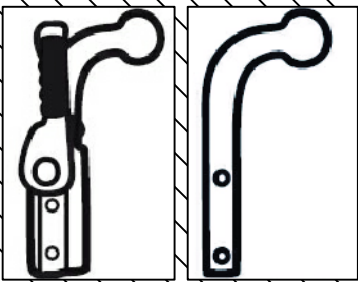
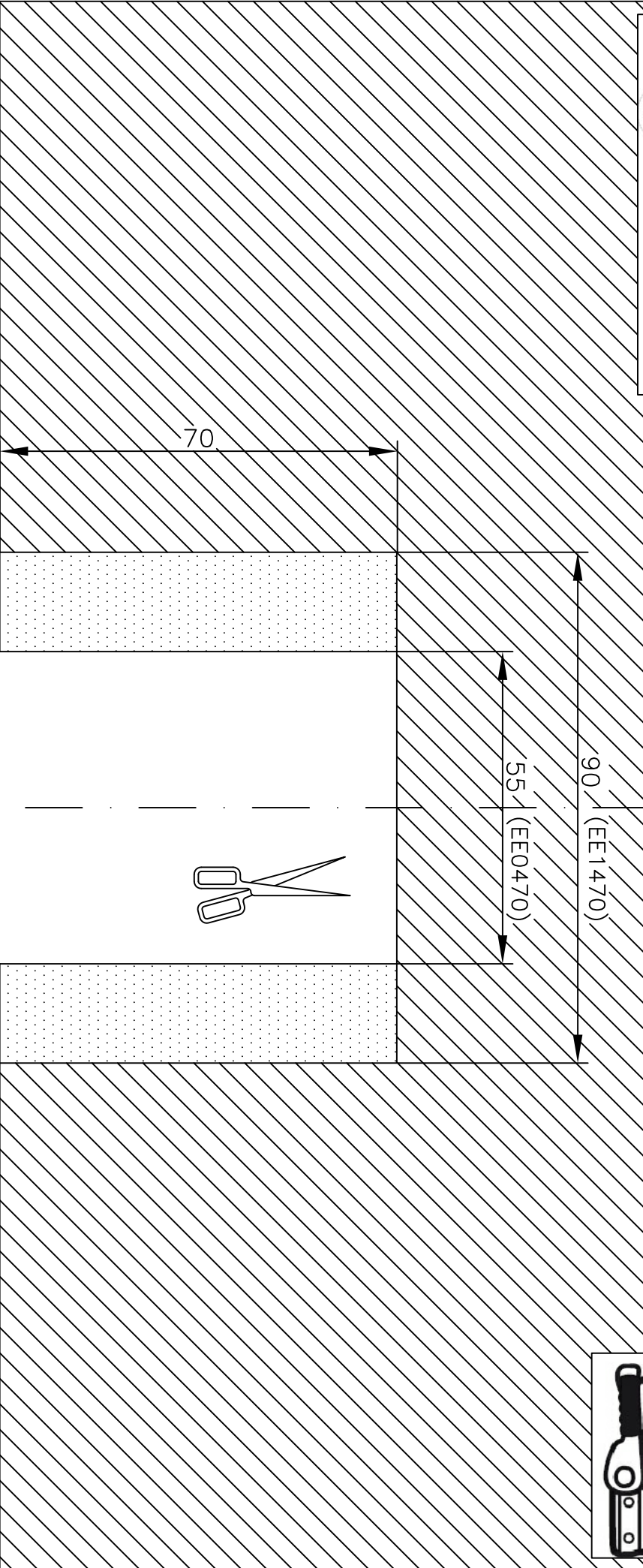

LINEA CENTRAL DEL PARAGOLPES



Dibujo:

CORTE PARAGOLPES  
FORD MONDEO

Escala:  
1:1

UNIDADES EN  
mm

EE0470-EE1470

Rev.  
P1

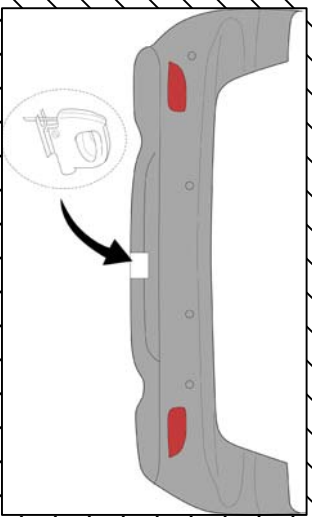

# CORTE PARAGOLPES

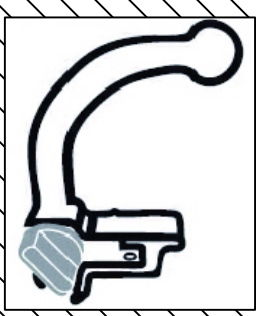
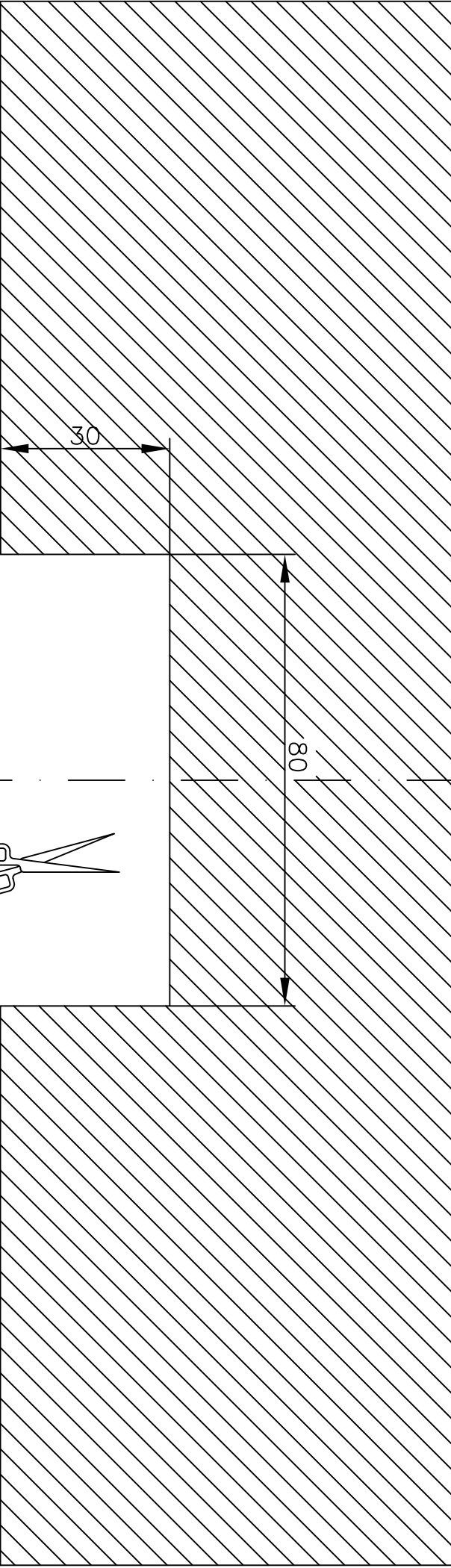

LINEA CENTRAL DEL PARAGOLPES



Dibujo:

CORTE PARAGOLPES  
FORD MONDEO

Escala:  
1:1

UNIDADES EN  
mm

EE4470

Rev.  
P1

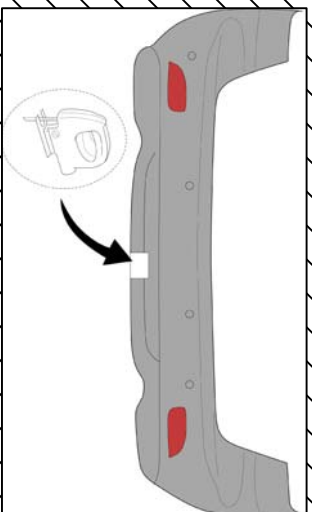

# CORTE PARAGOLPES

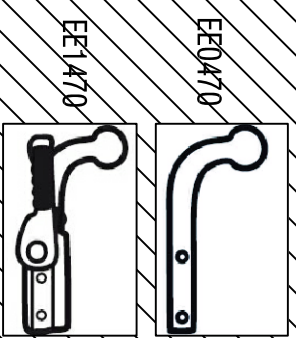
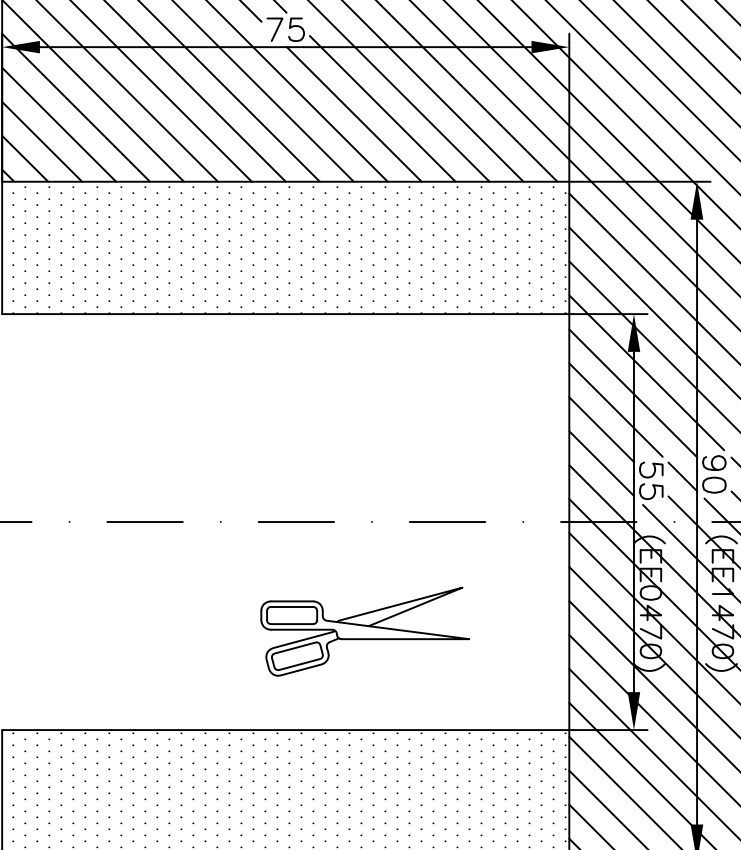

LINEA CENTRAL  
DEL PARAGOLPES

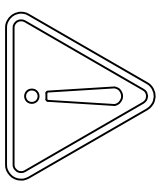

ESP: El corte es orientativo  
UK: The cut is indicative

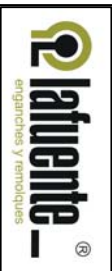

Dibujo:

CORTE PARAGOLPES  
FORD VIGNALE

Escala:  
1:1

UNIDADES EN  
mm

EE0470-EE1470

Rev.  
P1