

C		S		D
	1.505 kg.		85 kg.	7,65 kN

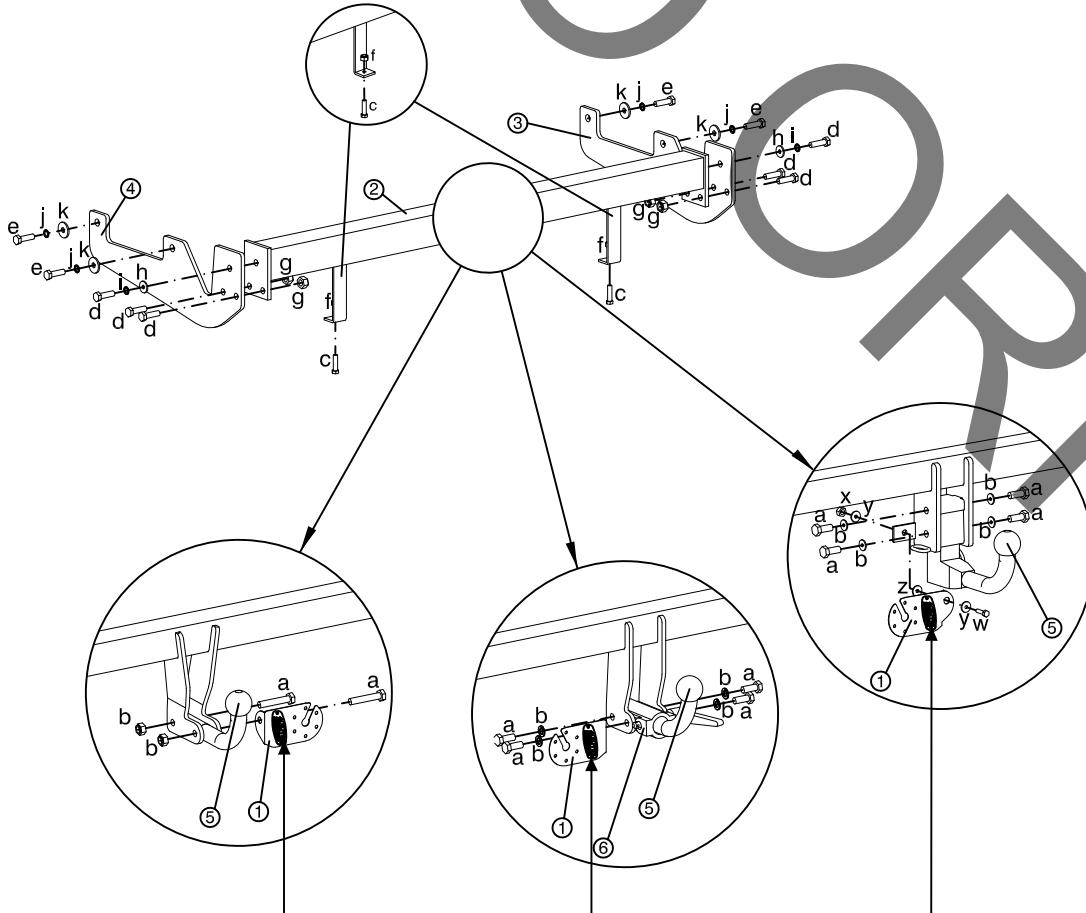

Made by LAFUENTE (SPAIN)
Tel. (+34) 952 625 840
www.lafuente.eu

Eg 55R -01 2517

TIPO EE0587 D 7,65 kN

CLASE A-50X S 85 kg

Made by LAFUENTE (SPAIN)
Tel. (+34) 952 625 840
www.lafuente.eu

Eg 55R -01 2518

TIPO EE1587 D 7,65 kN

CLASE A-50X S 85 kg

Made by LAFUENTE (SPAIN)
Tel. (+34) 952 625 840
www.lafuente.eu

Eg 55R -01 2519

TIPO EE4587 D 7,65 kN

CLASE A-50X S 85 kg

ELEMENTOS DE UNIÓN / CONNECTION COMPONENTS DAZUGEHÖRENDEN TEILEN / ÉLÉMENTS DE RACCORD			
BOLA / BALL / KUGEL / BOULE		VEHÍCULO / VEHICLE FAHRZEUG / VÉHICULE	
		c	2 x M6x15 DIN 6921 8.8
		d	6 x M10x35 DIN 933 8.8
		e	4 x M12x40 DIN 933 8.8
a		a	2 x M12x65 DIN 931 8.8
b		b	2 x M12 DIN 985 8
		f	2 x M6 DIN 6923 8
		g	4 x M10 DIN 985 8
		h	2 x M10 DIN 125 -
		i	2 x M10 DIN 6798 -
a		a	4 x M12x25 DIN 933 8.8
b		b	4 x M12 DIN 125 -
		j	4 x M12 DIN 6798 -
		k	4 x M12 DIN 9021 -
		w	1 x M10x30 DIN 933 8.8
		x	1 x M10 DIN 985 8
		y	2 x M10 DIN 125 -
		z	1 x M10 DIN 2093 -

Par de apriete para los tornillos/Tightening torque for bolts/Schrauben Drehmoment/Couple de serrage pour vis

Und.Nm	M6	M8	M10		M12			M14		M16
calidad	1	1,25	1,5	1,25	1,75	1,5	1,25	1,75	1,5	2
8.8	11,3	27,3	54,0	57,0	93,0	97,0	101,0	148,0	159,0	230,0
10.9	16,5	40,1	79,0	83,0	137,0	143,0	149,0	218,0	234,0	320,0
12.9	19,3	46,9	93,0	98,0	160,0	167,0	174,0	255,0	274,0	395,0

Este documento debe ser presentado en la I.T.V. junto con el certificado de montaje.

HERMANOS SÁNCHEZ-LAFUENTE,S.A. no asume ningún tipo de responsabilidad por daños causados por usos inadecuados.



DACIA SANDERO



EE0587



EE1587



EE4587

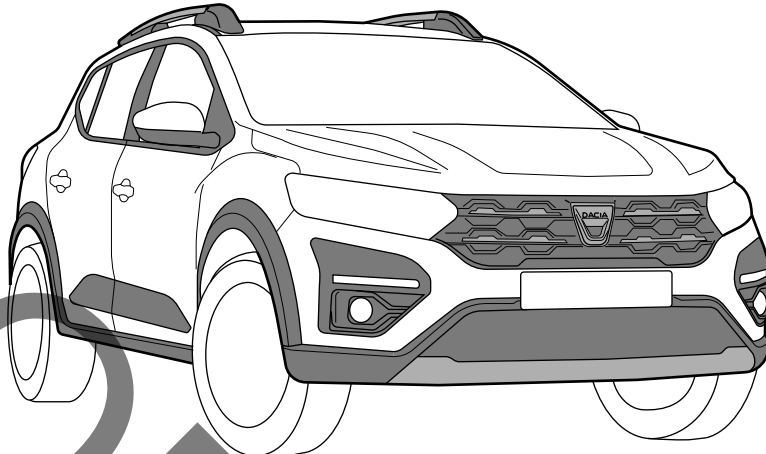

Instrucciones de montaje - Installation instructions - Notice de montage - Montageanleitung

1

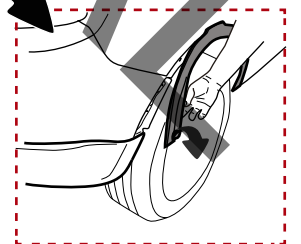
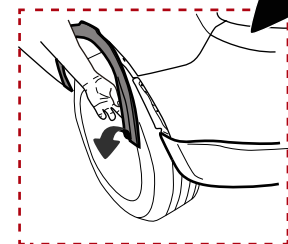
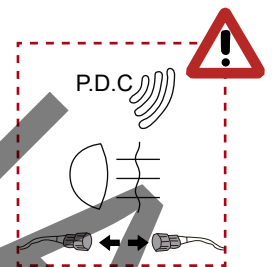
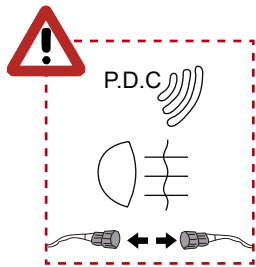

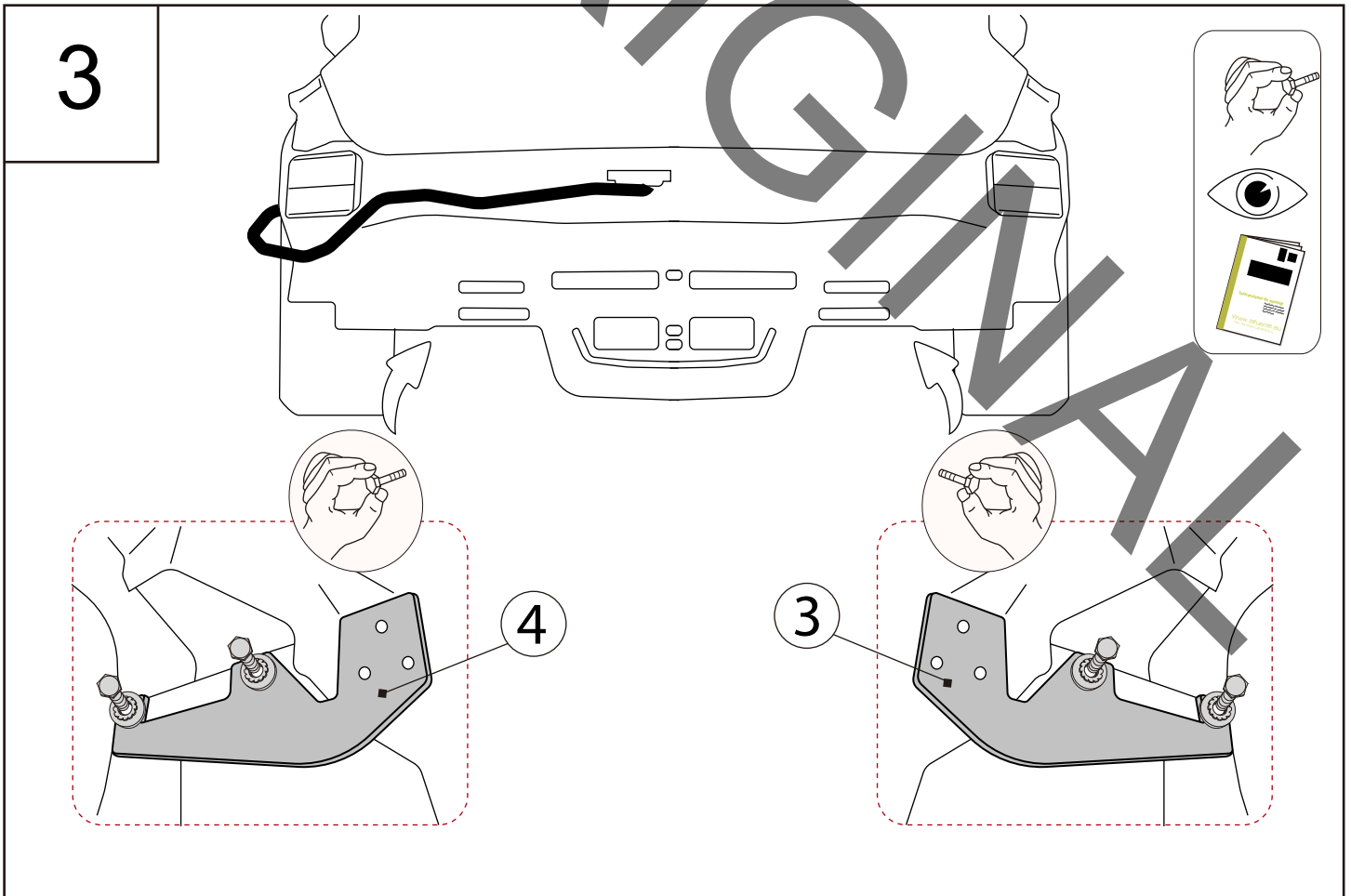
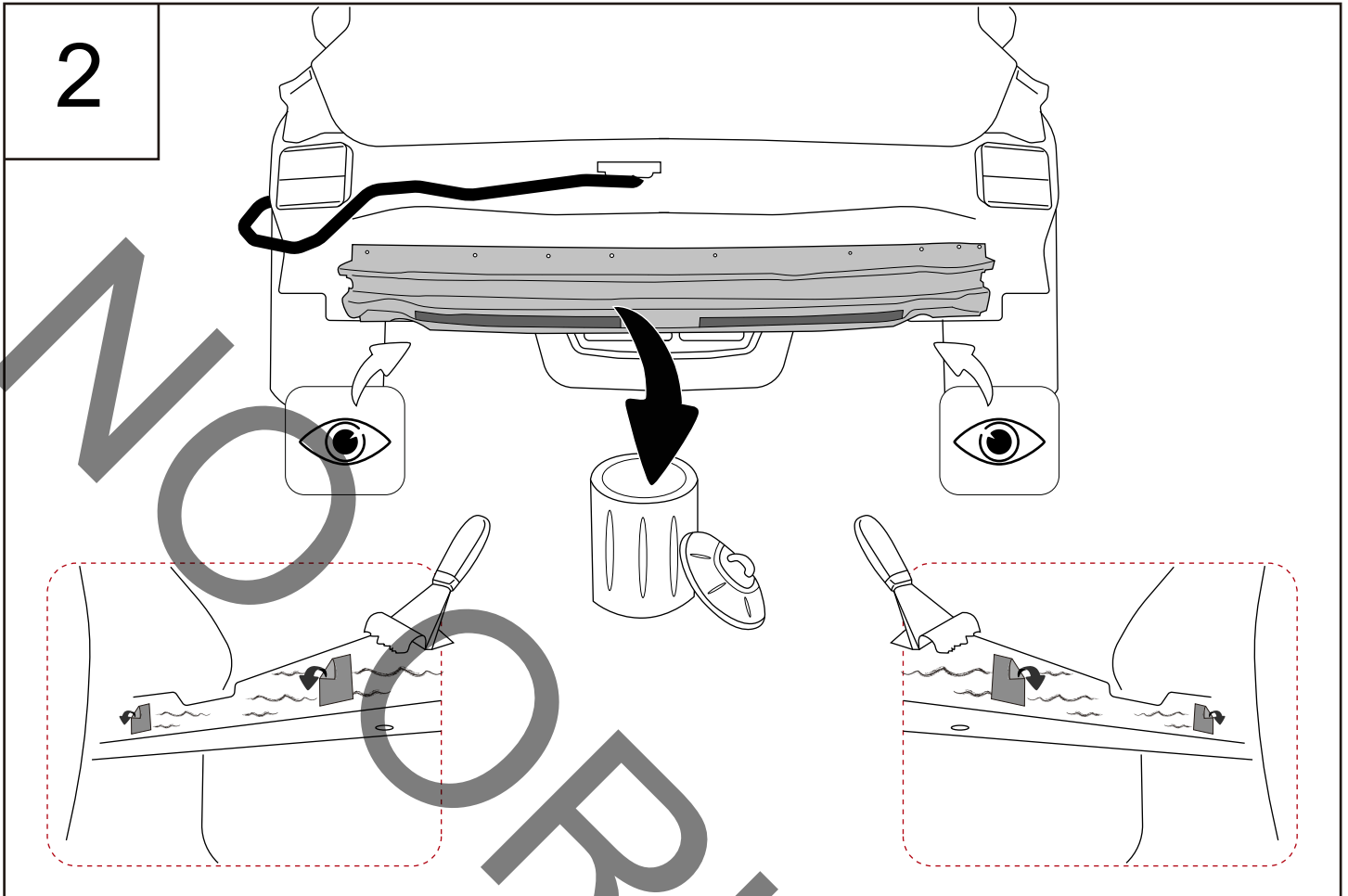

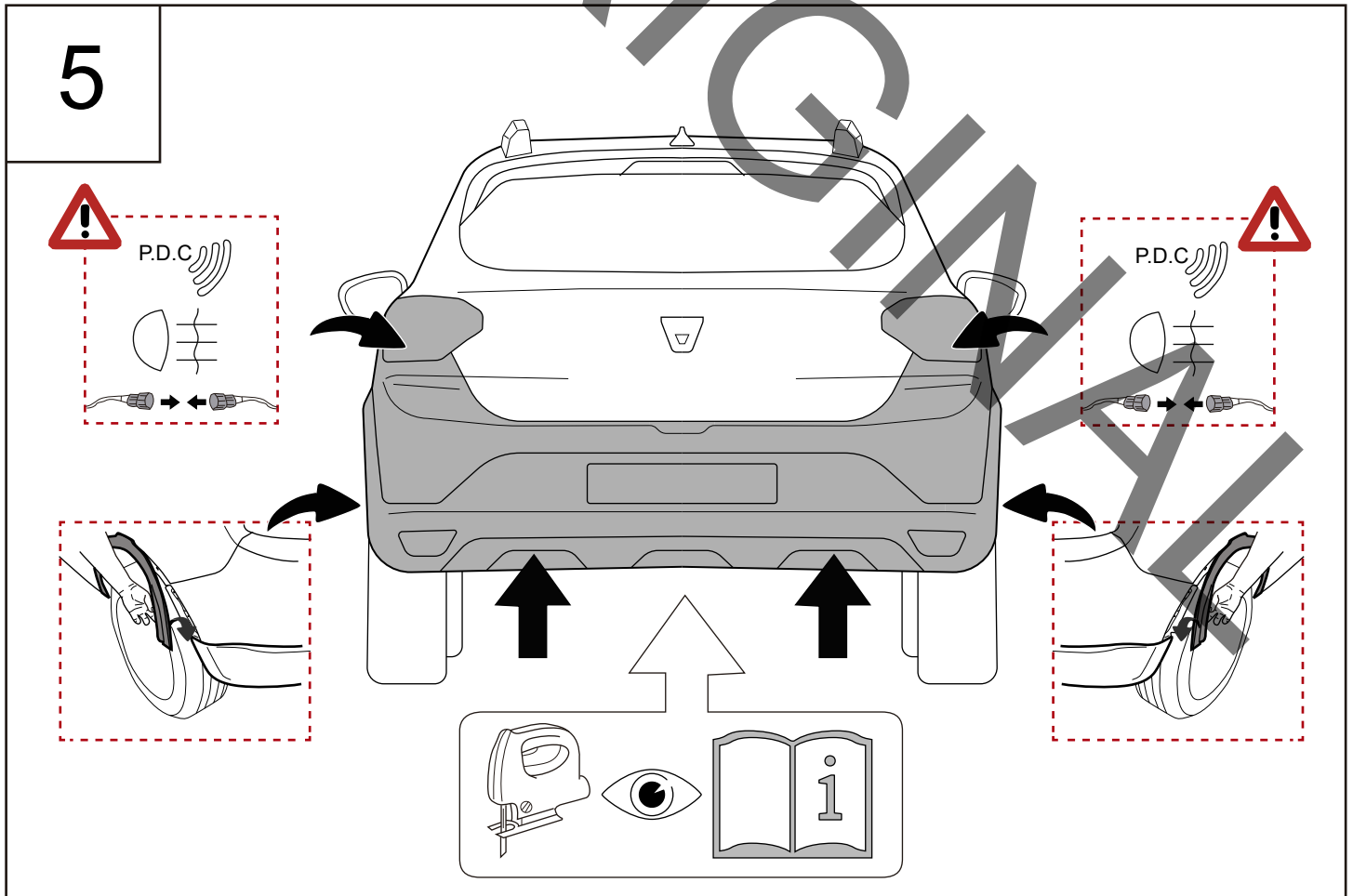
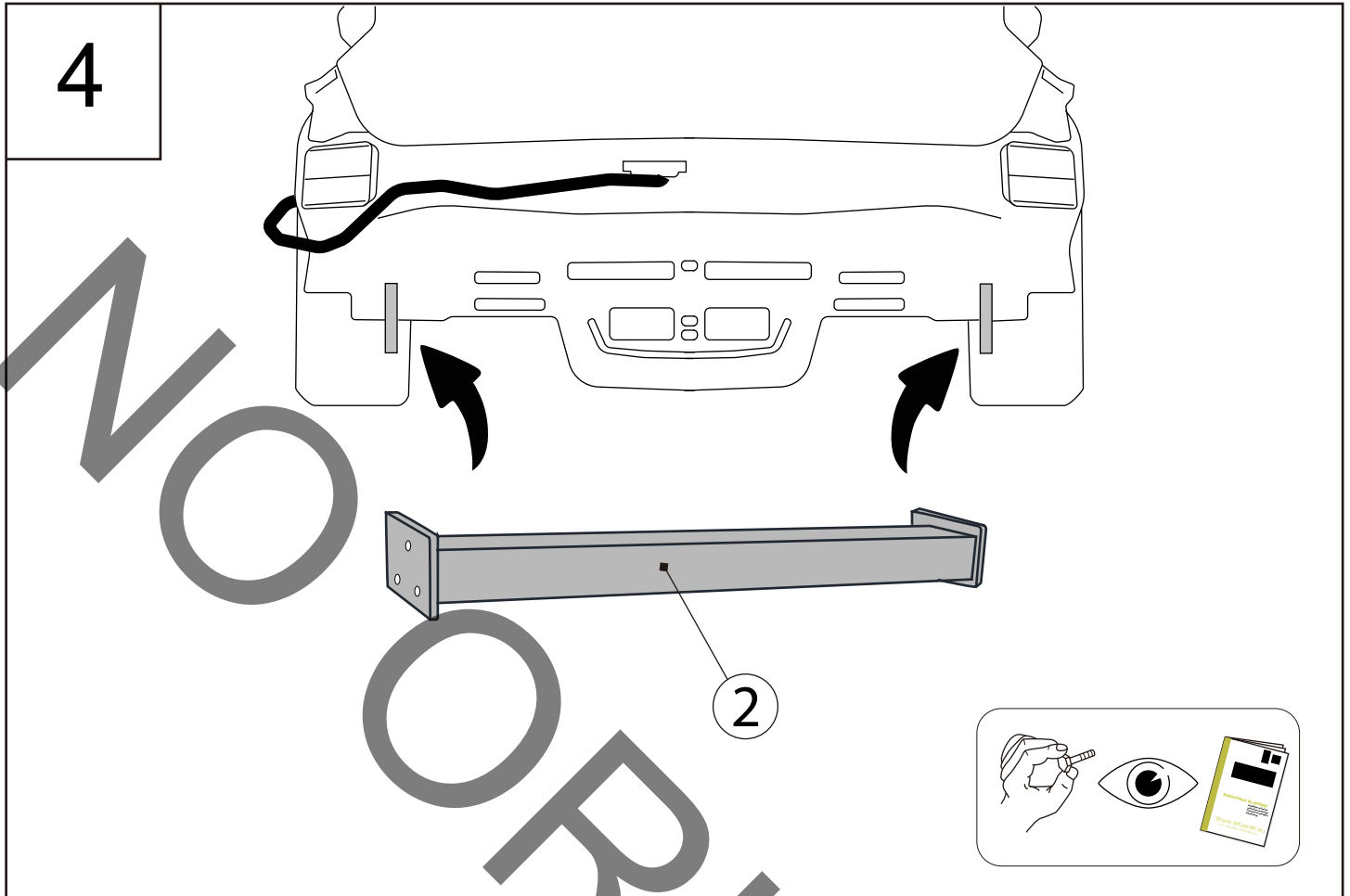

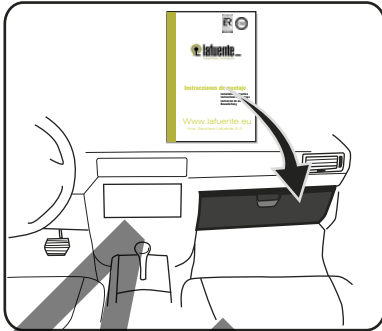

	M6	M8	M10	M12	M14	M16
8.8	10,4Nm	25,0Nm	51,0Nm	87,0Nm	140,0Nm	215,0Nm
10.9	15,5Nm	37,0Nm	75,0Nm	130,0Nm	205,0Nm	310,0Nm
12.9	18,0Nm	43,0Nm	87,0Nm	150,0Nm	240,0Nm	370,0Nm

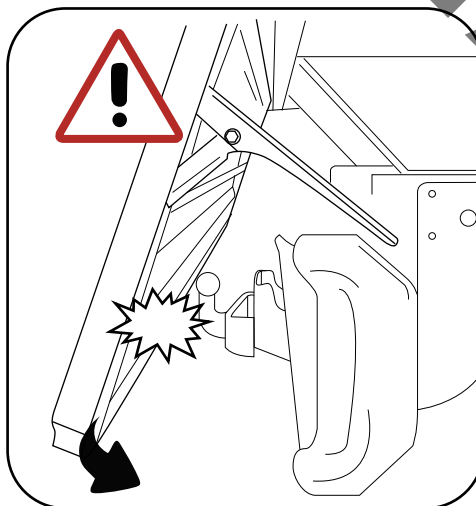
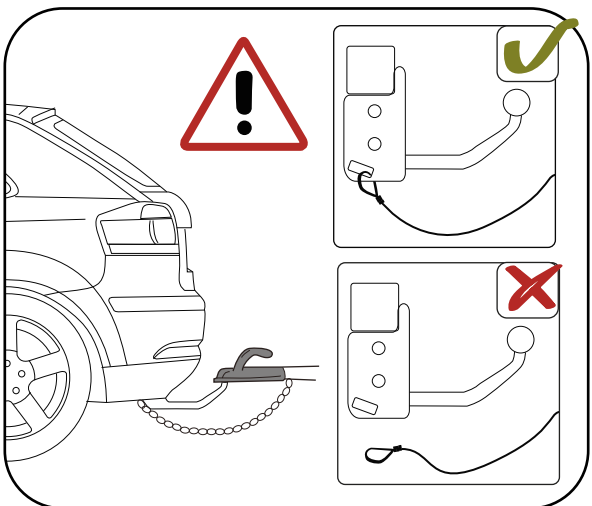
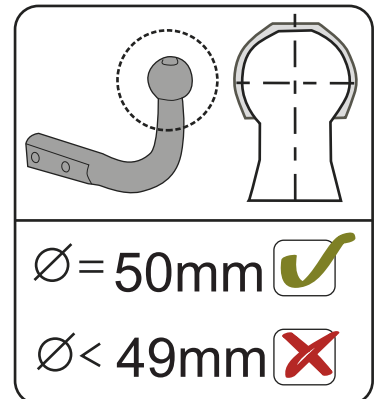
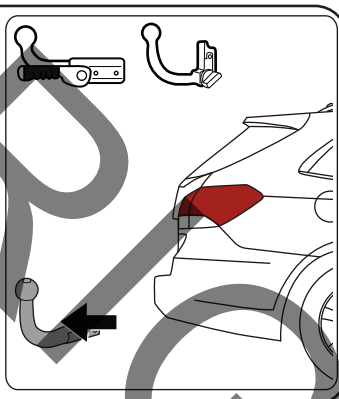
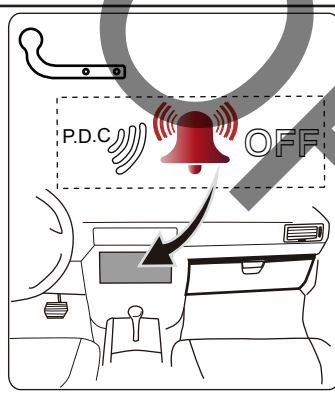
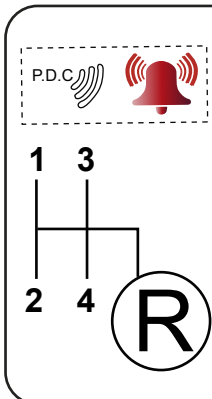
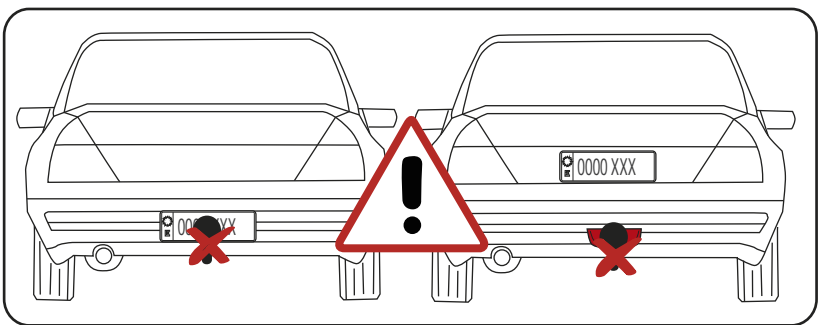
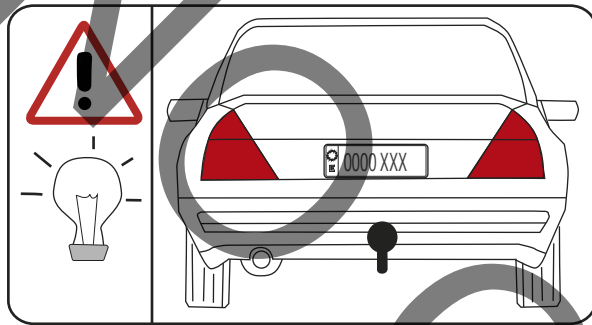

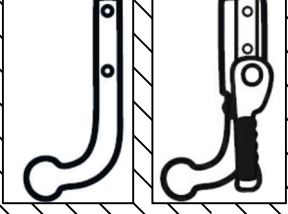

EE0587

EE1587

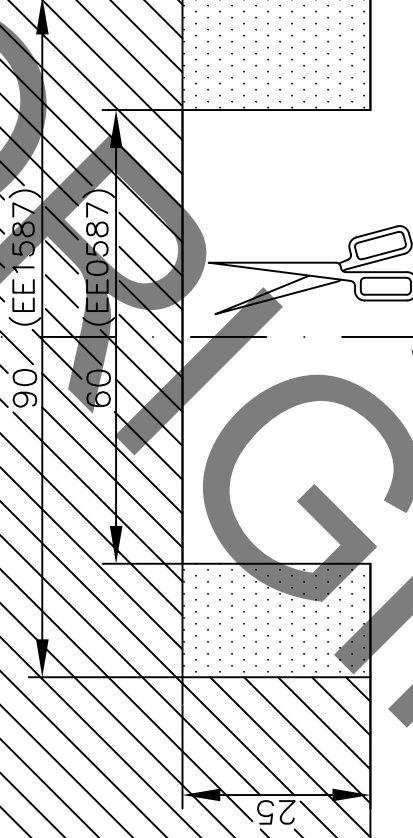

LINEA CENTRAL DE LA CARCASA

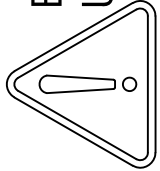

ESP: El corte es orientativo puede variar por modelo y año
UK: The cut is indicative it can change for model and year



Escala:
1:1

UNIDADES EN
mm

Dibujo:
CORTE CARCASA PARAGOLPES
DACIA SANDERO

EE0587-EE1587
Rev.
P1



EE4587

220

40

40

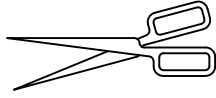

LINEA CENTRAL DE LA CARCASA

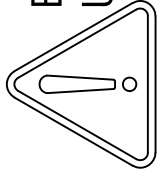

ESP: El corte es orientativo puede variar por modelo y año
UK: The cut is indicative it can change for model and year



Escala:
1:1

UNIDADES EN
mm

Dibujo:
CORTE CARCASA PARAGOLPES
DACIA SANDERO

EE4587

Rev.
P1